

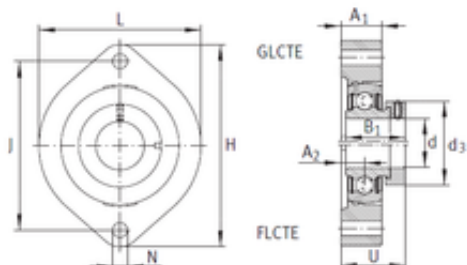

## NTN Bearing Driveshaft do Brasil

### INA FLCTE30 bearing units



Bearing No. FLCTE30

Bore Diameter	30 mm
d	30 mm
U	38,1 mm
d3	44 mm
A1	20,5 mm
B1	35,8 mm
H	112,5 mm
J	90,5 mm
L	84 mm
N	11,5 mm
A2	11,4 mm
Weight	0,76 Kg
Basic dynamic load rating (C)	19,5 kN
Category	Flange Block Bearings
Inventory	3.0
Manufacturer Name	SCHAEFFLER GROUP
Minimum Buy Quantity	N/A
Weight / Kilogram	0.76
EAN	4012802792027
Product Group	M06110
Number of Mounting Holes	2
Mounting Method	Eccentric Collar
Housing Style	2 Bolt Flange Block
Rolling Element	Ball Bearing
Housing Material	Cast Iron
Expansion / Non-expansion	Non-expansion

FLCTE30 Bearing 2D drawings and 3D CAD models



## NTN Bearing Driveshaft do Brasil

Mounting Bolts	11.5 Millimeter
Relubricatable	No
Insert Part Number	RAE30NPPB
Seals	Double Lip Contact
Housing Configuration	1 Piece Solid
Pilot Configuration	No Pilot
Inch - Metric	Metric
Long Description	2 Bolt Flange Block; 30MM Bore; 90.5MM Bolt Circle; 90.5MM Bolt Spacing; 1 Piece Solid; Eccentric Collar Mount; Cast Iron; Ball Bearing; 35.7MM Length Thru Bore; No Relubricatable; Double Lip Contact
Other Features	Single Row   Small Center Bolt   With Set Screw
Category	Flange Block
UNSPSC	31171501
Harmonized Tariff Code	8483.20.40.40
Noun	Bearing
Keyword String	Flanged
Manufacturer URL	<a href="http://www.ina.com">http://www.ina.com</a>
Manufacturer Item Number	FLCTE30
Weight / LBS	1.676
Cartridge Pilot Depth	0 Inch   0 Millimeter
Nominal Bolt Circle Diameter Round	3.6 Inch   90.5 Millimeter
Bolt Spacing	3.563 Inch   90.5 Millimeter
Cartridge Pilot Diameter	0 Inch   0 Millimeter
Bore	1.181 Inch   30 Millimeter
Length Thru Bore	1.406 Inch   35.7 Millimeter